

*A*marr®

# SUPERFLEX Panel

## Installation and Owner's Manual



---

**▲ WARNING**

*Do not install, operate or service this product unless you have read and understand the Safety Practices, Warnings, and Installation and Operating Instructions contained in this manual. Failure to do so could result in death or serious injury.*

For Professional Dealer Installation

# LIMITED WARRANTY

---

THIS LIMITED WARRANTY IS APS RESOURCE'S SOLE AND EXCLUSIVE WARRANTY WITH RESPECT TO THE DOOR PANEL AND IS IN LIEU OF ANY OTHER GUARANTEES OR WARRANTIES, EXPRESS OR IMPLIED.

Amarr Company warrants that this SUPERFLEX Panel will be free from flaws in material and workmanship under normal use for a period of two (2) years from the earlier of 1) 60 days after the date of initial shipment by Amarr, or 2) the date of installation of the SUPERFLEX Panel by the original purchaser, provided that the owner maintains and operates the SUPERFLEX Panel in accordance with this User's Manual.

In the event that this SUPERFLEX Panel proves deficient in material or workmanship within the applicable Limited Warranty period, owner shall so notify Amarr Company, and Amarr Company will, at its option:

1. Replace the SUPERFLEX Panel, or the deficient portion(s) thereof, without charge to the owner;

or

2. Alter or repair the SUPERFLEX Panel, on site or elsewhere, without charge to the owner.

This Limited Warranty does not cover any failure caused by improper installation, abuse, improper operation, negligence, or failure to maintain and adjust the SUPERFLEX™ Panel properly. Parts requiring replacement due to damage resulting from vehicle impact, abuse, or improper operation are not covered by this warranty. AMARR DISCLAIMS ANY RESPONSIBILITY OR LIABILITY FOR ANY LOSS OR DAMAGE OF ANY KIND (INCLUDING WITHOUT LIMITATION, DIRECT, INDIRECT, CONSEQUENTIAL OR PUNITIVE DAMAGES, OR LOST PROFITS OR LOST PRODUCTION) arising out of or related to the use, installation or maintenance of the SUPERFLEX Panel (including premature product wear, product failure, property damage or bodily injury resulting from use of unauthorized replacement parts or modification of the SUPERFLEX Panel). Entrematic's sole obligation with regard to a SUPERFLEX Panel that is claimed to be deficient in material or workmanship shall be as set forth in this Limited Warranty. This Limited Warranty will be null and void if the original purchaser does not notify the Amarr warranty department within ninety (90) days after the product deficiency is discovered.

THERE ARE NO WARRANTIES, EXPRESS OR IMPLIED, WHICH EXTEND BEYOND THE DESCRIPTION ON THE FACE HEREOF, INCLUDING, BUT NOT LIMITED TO, A WARRANTY OF MERCHANTABILITY OR OF FITNESS FOR A PARTICULAR PURPOSE, ALL OF WHICH AMARR HEREBY DISCLAIMS.

**KEEP THIS DOCUMENT FOR YOUR RECORDS – DO NOT REMIT**

Amarr Service Center  
3800 Greenway Circle  
Lawrence, KS 66046  
ask.amarr@amarr.com

## SAFETY SIGNAL WORDS

---

You may find safety signal words such as DANGER, WARNING or CAUTION throughout the owner's manual.



*This is the safety alert symbol. It is used to alert you to potential personal injury hazards. Obey all safety messages that follow this symbol to avoid possible injury or death.*

### **▲ DANGER**

*Indicates an imminently hazardous situation which, if not avoided, will result in death or serious injury.*

### **▲ WARNING**

*Indicates a potentially hazardous situation which, if not avoided, could result in death or serious injury.*

### **▲ CAUTION**

*Indicates a potentially hazardous situation which, if not avoided, may result in minor or moderate injury.*

### **NOTICE**

*Notice is used to address practices not related to personal injury.*

# SAFETY PRACTICES

## SAFETY PRACTICES

### **▲ WARNING**

***Read and follow these safety practices as well as those in the manufacturer's original product manual for the door before installing, operating or servicing the door. All SUPERFLEX panels are to be installed according to the Safety Practices and installation instructions listed and described in this manual. Failure to follow the Safety Practices could result in death or serious injury.***

If you do not understand the instructions, ask your supervisor to explain them to you, or call Amarr Company at (800) 503-DOOR.

## INSTALLATION / MAINTENANCE / SERVICE

- The SUPERFLEX Panel should not be used in a vertical lift (top lift) door application where the cable attaches to the top sectional panel. The SUPERFLEX Panel should only be used in applications where the cable attaches to the bottom bracket on the bottom sectional panel.
- The SUPERFLEX Panel is intended only to be installed as the bottom panel of an overhead door.
- ONLY experienced and qualified door technicians should install or repair panels. Springs, cable brackets, cables, drums, supports and their hardware are under high tension and can cause injuries if not properly handled.
- Use the proper type and capacity aerial equipment, lifting equipment and safety straps or harnesses.
- Safe and efficient installation requires a two-person crew.
- Observe OSHA requirements for "LOCKOUT" or "TAGOUT" when performing work on panels.
- Observe any/all overhead hazards such as electrical, air, piping or HVAC ducting when working.
- Move any dock leveler to the dock level storage position before using as a platform for ladders, lift trucks or other equipment used in the installation of the panel.

## OPERATION

- Personnel using the dock doors MUST BE properly trained.
- Operate door ONLY when properly adjusted and free of obstructions. Should the door become difficult to

operate or completely inoperative, immediately report to supervisor.

- DO NOT stand or walk under moving door. Keep door in full view and free of obstructions.
- DO NOT throw door up violently. Using excessive force to open the door may cause the door cables to jump off of drums or door panels to disengage from tracks.
- DO NOT close door onto obstructions. Obstructions in the opening may stop the doors movement and cause the door cables to jump off of drums or door panels to disengage from tracks.
- To avoid injury, keep hands free of door parts while operating. Door parts may create pinch points when in operation.
- NEVER use damaged or malfunctioning SUPERFLEX panel.

## IMPACT SITUATION

1. In the event of a panel or track impact situation, step away from the door a safe distance.
2. Inspect the door system BEFORE using the dock door and SUPERFLEX Panel again.
  - Check panels, tracks, roller bearings, hardware and fasteners for any damage, looseness and misalignment.
  - Cables MUST BE undamaged, securely attached to cable brackets, properly tensioned and seated in the grooves of the cable drums.
  - Panels MUST BE sitting level with the hinges and hardware intact.
  - Tracks MUST BE square to jamb face, properly attached and able to securely guide the roller bearings throughout their travel range.
  - The roller bearing of all panels MUST BE engaged in the track on both sides.

**If any of these conditions are not met, DO NOT use door. Stay clear of door and immediately report incident to supervisor. Have a trained door systems technician inspect, correct any problems, and reset door.**

3. NEVER climb under door panels.
4. Carefully cycle the door to its fully open and closed position several times making sure operation is smooth throughout its entire travel cycle.

# INSTALLATION

---

## TOOLS AND MATERIALS

---

The following tools & materials are necessary for proper installation of the SUPERFLEX Panel and are not provided by APS Resource.

- Spring winding bars. Refer to the original door owner's manual for complete instructions and spring winding bars sizes.
- Aerial equipment, scaffolding, scissors lift or boom lift
- Hand tools: 7/16" & 1/2" sockets and ratchet, level, clamps, locking pliers, hammer, screwdrivers, and tape measure.

## INSTALLATION

---

### **▲ WARNING**

*Read and follow all safety practices and instructions in the manufacturer's original product manual for the door. All SUPERFLEX panels are to be installed according to the safety practices and installation instructions listed and described in this manual. Failure to follow these instructions could result in death or serious injury.*

### **▲ WARNING**

*The spring assembly, which includes the springs, spring anchor brackets, cables, cable drums and bearing brackets, is under extreme tension and if handled improperly, could result in death or serious injury. Spring assemblies should ONLY be installed, adjusted or repaired by a trained door systems technician. Winding bars MUST fit snugly into the holes in the winding cone. NEVER use smaller rods or screwdrivers as winding bars. Failure to use proper winding bars could result in death or serious injury.*

### **▲ WARNING**

*The SUPERFLEX Panel should not be used in a vertical lift (top lift) door application where the cable attaches to the top sectional panel. The SUPERFLEX Panel should only be used in applications where the cable attaches to the bottom bracket on the bottom sectional panel.*

### **NOTICE**

The SUPERFLEX Panel is intended only to be installed as the bottom panel of an overhead door.

Instructions indicating left or right are based on facing the door from inside the building.

## REMOVAL OF EXISTING PANEL

1. Securely lock all existing door panels in the "DOWN" position; with the exception of the existing bottom panel. This will prevent the door from moving while unwinding the springs.
2. Lock out the shaft and unwind the springs. Refer to the original door owner's manual for complete instructions.
3. Disconnect hinges from the existing bottom panel
4. Completely remove center hinge(s), if any, connected to the existing bottom panel, and discard.
5. Disconnect the cables from the existing bottom panel
6. Remove the existing bottom panel being replaced.

# INSTALLATION

## PANEL INSTALLATION

1. Insert the right hand roller bearing into the channel of the track until it is engaged correctly.
2. Attach cable to the right hand bottom bracket using clevis pin and cotter pin. Secure the cotter pin by properly bending both ends around the clevis pin.
3. Slide right hand bottom bracket onto the roller and adjust the position of the bracket for proper alignment.
4. Repeat steps 1 through 3 to install the left hand side bottom bracket.
5. Place the SUPERFLEX panel into mounting position. Verify rollers are positioned correctly and the panel is aligned with the door tracks and existing panels.
6. Securely fasten the removed hinges to the SUPERFLEX panel using self drilling screws provided. Only the hinges on the left and right ends of the panel should be attached. **DO NOT** attach any center hinge(s). **IT MAY BE NECESSARY TO FIRST DRILL PILOT HOLES USING A CARBIDE DRILL BIT. (3/16" DIAMETER RECOMMENDED).**

### NOTICE

**DO NOT attach any center hinge(s) to the SUPERFLEX Panel. Doing so will cause the FLEX-BACK Panel to function improperly and will cause damage to door panel(s) connected to the FLEX-BACK Panel.**

7. Securely fasten the bottom brackets to the FLEX-BACK panel using self drilling screws. **IT MAY BE NECESSARY TO FIRST DRILL PILOT HOLES USING A CARBIDE DRILL BIT. (3/16" DIAMETER RECOMMENDED).**
8. Securely fasten the door handle to the steel mounting plate using self drilling screws (optional). **IT MAY BE NECESSARY TO FIRST DRILL PILOT HOLES USING A CARBIDE DRILL BIT. (3/16" DIAMETER RECOMMENDED).**
9. If an existing door slide lock is on the removed panel, and it is in good condition, it may be reused. A new slide lock is **NOT** included with the SUPERFLEX panel.
10. Tie the pull rope onto the door handle (optional). **DO NOT INSTALL PULL ROPE ON DOORS WITH POWERED OPERATORS**
11. Remove the clear, protective film from the inside and outside skins of the door panel.
12. Mount the warning placard near the door.

## WINDING SPRINGS

### ▲ WARNING

***Depending on the configuration of the existing dock door, the door springs may need additional adjustment after the SUPERFLEX panel is installed.***

1. Check stacked panels for level.
2. Verify that the cable attachment bracket is installed on the SUPERFLEX panel correctly.
3. Securely lock door in down position to prevent door from opening while winding springs.
4. Before proceeding refer to the original door owner's manual for complete winding instructions.
5. Carefully cycle the door to its fully open and closed position several times making sure operation is smooth throughout its entire travel cycle.

# OPERATION/MAINT.

## OPERATION

### ⚠ WARNING

**Before operating the door, read and follow the safety practices in this manual and in the manufacturer's original product manual for the door. Stand back. Moving door can crush you. Keep people clear while door is moving. Failure to follow these instructions could result in death or serious injury. NEVER climb under door panels.**

1. Verify the door, tracks, hinges and springs are free of obstructions.
2. Lift and lower door with proper ergonomic methods by using supplied pull rope and door handle. DO NOT use a fork truck or other material handling equipment to raise or lower the loading dock door
3. Raise and lower door slowly and maintain an even door travel speed. Keep door in full view. NEVER throw door up or pull door down at high speed.

## MAINTENANCE SCHEDULE

### ⚠ WARNING

**Before servicing the door, read and follow the safety practices in this manual and in the manufacturer's original product manual for the door. DO NOT attempt to repair or adjust SUPERFLEX panel components unless you are a qualified door technician. Springs, cable brackets, cables, drums, supports and their hardware are under extreme tension and can cause injuries if not properly handled. Always follow the maintenance schedule below AND the original manufacturer's maintenance schedule to ensure all components are in good working condition. Damaged or worn parts MUST BE replaced immediately for proper and safe operation. It is recommended that the door be made inoperative until the damaged or worn parts have been replaced. Observe OSHA requirements for "LOCK OUT" or "TAGOUT" when performing work on the door. Disconnect power before performing maintenance or repair of electrical devices. Refer to the original owner's manual for complete instructions on safety practices and maintenance.**

ITEM	PROCEDURE	INSPECT INTERVALS		
		Daily	Monthly	Every 3 Months
Operation	Manually operate the door. Check for smooth operation and proper balance. If this door has an automatic opener, disconnect it before this inspection.	✓		
Labels	Inspect all safety/warning/product labels, placards, decals, tags. Replace if damaged or missing.		✓	
Cables	Check for signs of abnormal wear, fraying or damage.			✓
Cable Attachments	Check for signs of abnormal wear or damage and properly secure all fasteners.			✓
Track	Check for signs of abnormal wear or damage.	✓		
Rollers	Check for signs of abnormal wear or damage. Lubricate.			✓
Hinges	Check for signs of abnormal wear or damage.			✓
Fasteners	Check and properly secure all fasteners.			✓
Panels	Check for signs of abnormal wear or damage.	✓		
Panels	Clean with a dish detergent and water mixture ONLY.	As Needed		
Seals	Check for signs of abnormal wear or damage.			✓



# PARTS LIST

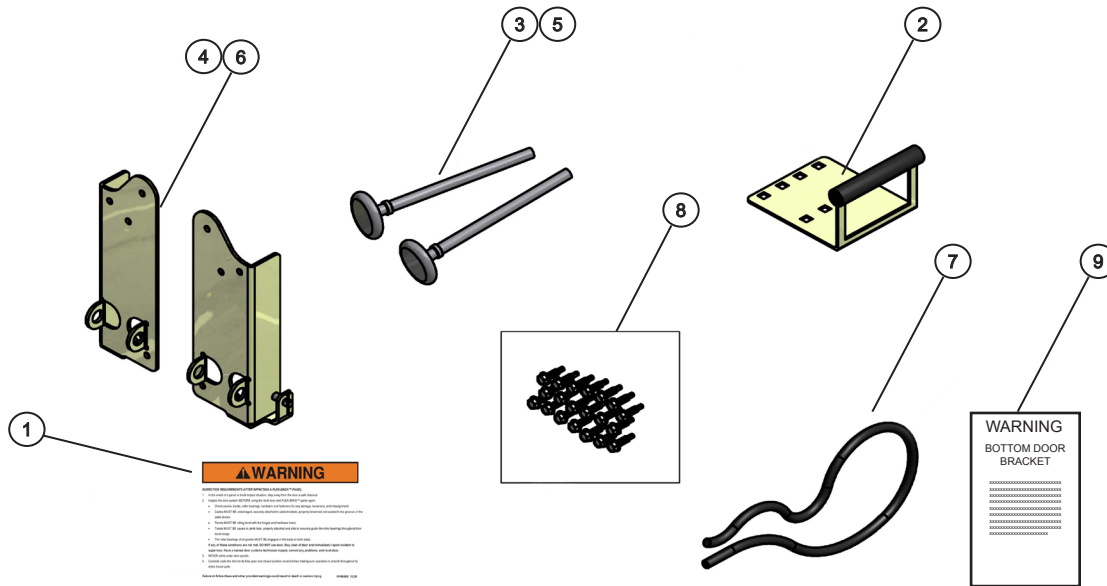

ITEM	P/N	DESCRIPTION	QTY
1	AP4649	Placard, SUPERFLEX Warning	1
2	AP4682	Heavy-Duty Handle	1
3	AP4683	2" Steel Roller, 7" Stem	2
4	AP4684	Kit, 2" Bottom BKT, RH&LH w/ Clevis & Cotter Pins	1
5	AP4701	3" Steel Roller, 7" Stem	2
6	AP4702	Kit, 3" Bottom BKT, RH&LH w/ Clevis & Cotter Pins	1
7	AP4685	Pull Rope, 8 FT. Long	1
8	AP4686	Kit, Tek Screws (Pkg of 20)	1
9	AP5012	Safety Label, Bottom Door Bracket Warning (Located Next To Each Bottom Bracket)	2

## COMPLETE PANEL ASSEMBLY P/N's

PANEL WIDTH	PANEL HEIGHT	ROLLER SIZE	
		2" Roller	3" Roller
8' 2"	24"	AP4660	AP5060
8' 8"	24"	AP4661	AP5061
9' 2"	24"	AP4662	AP5062
9' 8"	24"	AP4663	AP5063
10' 2"	24"	AP4664	AP5064
12' 2"	24"	AP4665	AP5065

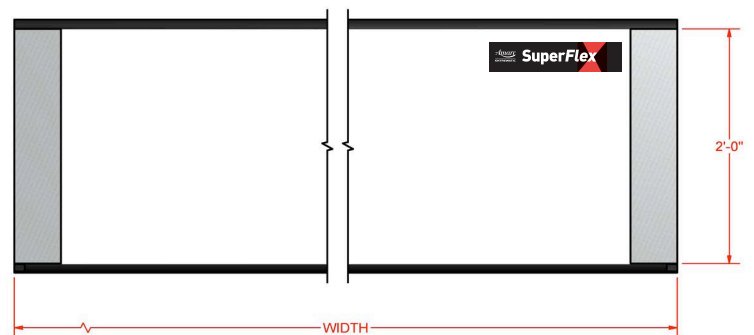

Please direct questions to your local Amarr Door Center

